

LOG CABIN SHINGLE TILE INSTRUCTION



The Cabin Group and all our associated companies, brands dealers or agents are not responsible for water leakages due to incorrect tile installation or improper preparation of the roof deck. Please therefore read the instructions carefully. If you have any installation questions please ask us before starting.

Sometimes there are small differences in the colour of the tiles. This is not a defect of the material and is actually designed to increase the decorative beauty of the completed roof. In order to reduce colour difference during installation of the tiles, it is recommended to mix tiles from packs at random.

Storage

Each pack of tiles should be bent and shaken before opening, this helps to separate the shingles from each other. It is not recommended to walk on the roof in hot/sunny weather because the cover might be damaged. Special ladders

Usage of materials for roofing cover

Each pack of tiles contains 3 m² of tile coverage (including overlapping). Each pack of ridge tiles contains 5m² of tile coverage (including overlapping).

When calculating the amount of materials needed for roofing cover it is necessary to evaluate the quantity of tiles required depending on the complexity, degree of slope and size of the roof. Wastage of about 5 to 15% is normal. Extra tiles left should be stored correctly and can be used to repair any areas of damage in the future.

Installation of bitumen shingles

Start the first row of tiles at the bottom of the roof edge (eaves). (see picture) Use a standard tile and turn so flat edge is placed 1 inch over the roof edge. Then lay another row of tiles over the first row this time the correct way round. The silicon film should be removed from the underside of the tile prior to installation.

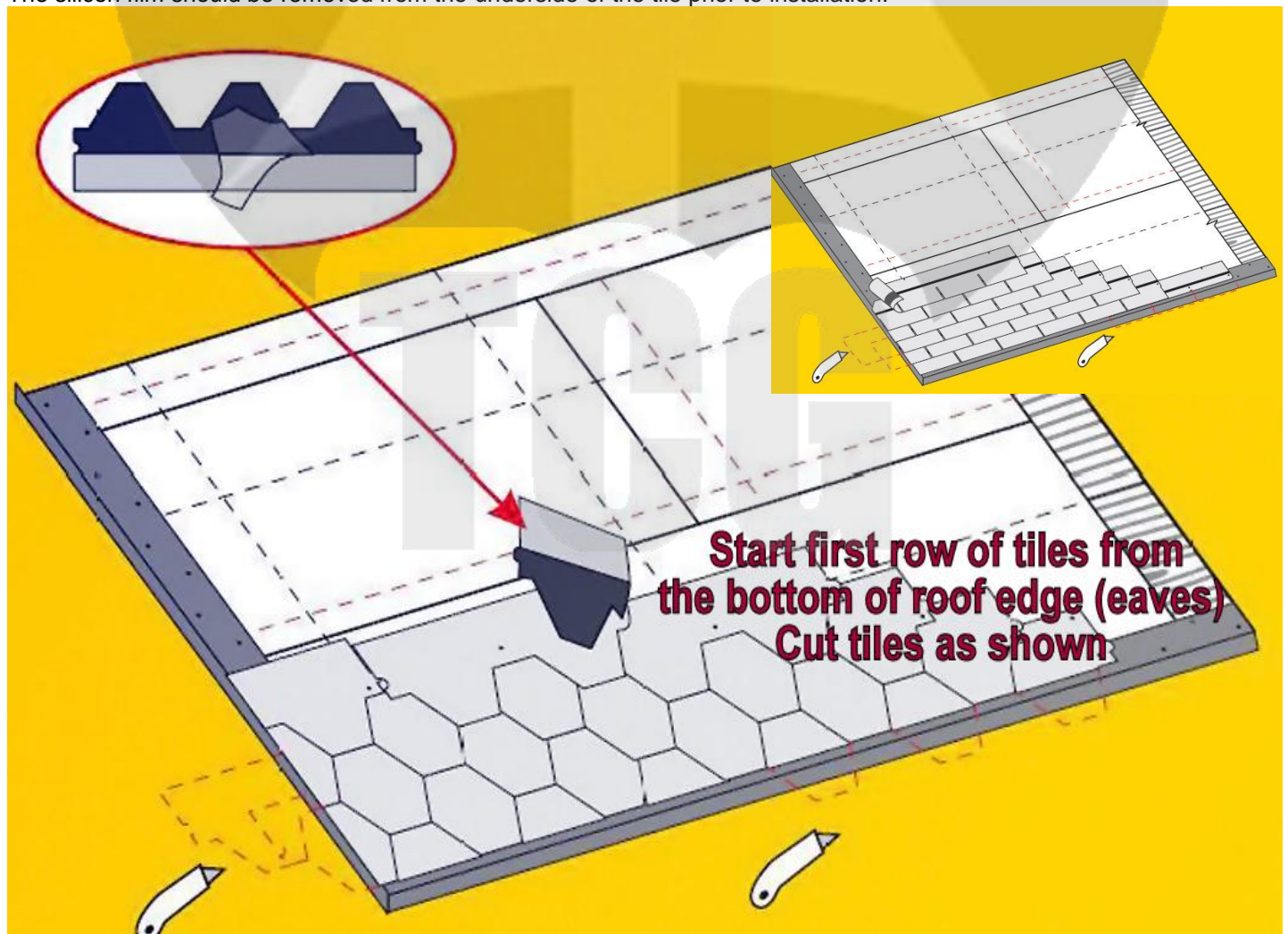

Continue upwards, cutting the tiles along the edges of the apexes to top of roof (ridge). Complete the same on the other side of the roof starting from the bottom of the roof (eaves) to the top (ridge), use a quality silicone or gutter sealant along the apex edge after you fix the fascia boards. Overlap slightly the roof top (ridge) to give extra protection.

Every tile should be nailed to the roof boards with wide headed galvanized roof tack nails. The number of nails depends on the pitch or slope of your roof. It is very important not to over hit the nails. The head of the nail should not puncture the surface of the shingle tile.

The nails are put 2 – 3 cm from the edge of the tile. Picture on the left indicate the number of nails needed and where they should be applied at certain roof angle. The picture shows the topside of the tile, and the dotted line indicates the place of the adhesive bottom layer.

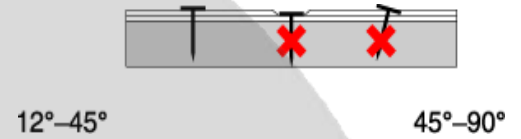

Ridge/cornice tiles should be cut into three parts at the places of perforation and laid in a straight line with an overlap of 3 – 5 cm. Fix with two nails on each side of the slope. Tiles should be fixed against the prevailing direction of the wind.

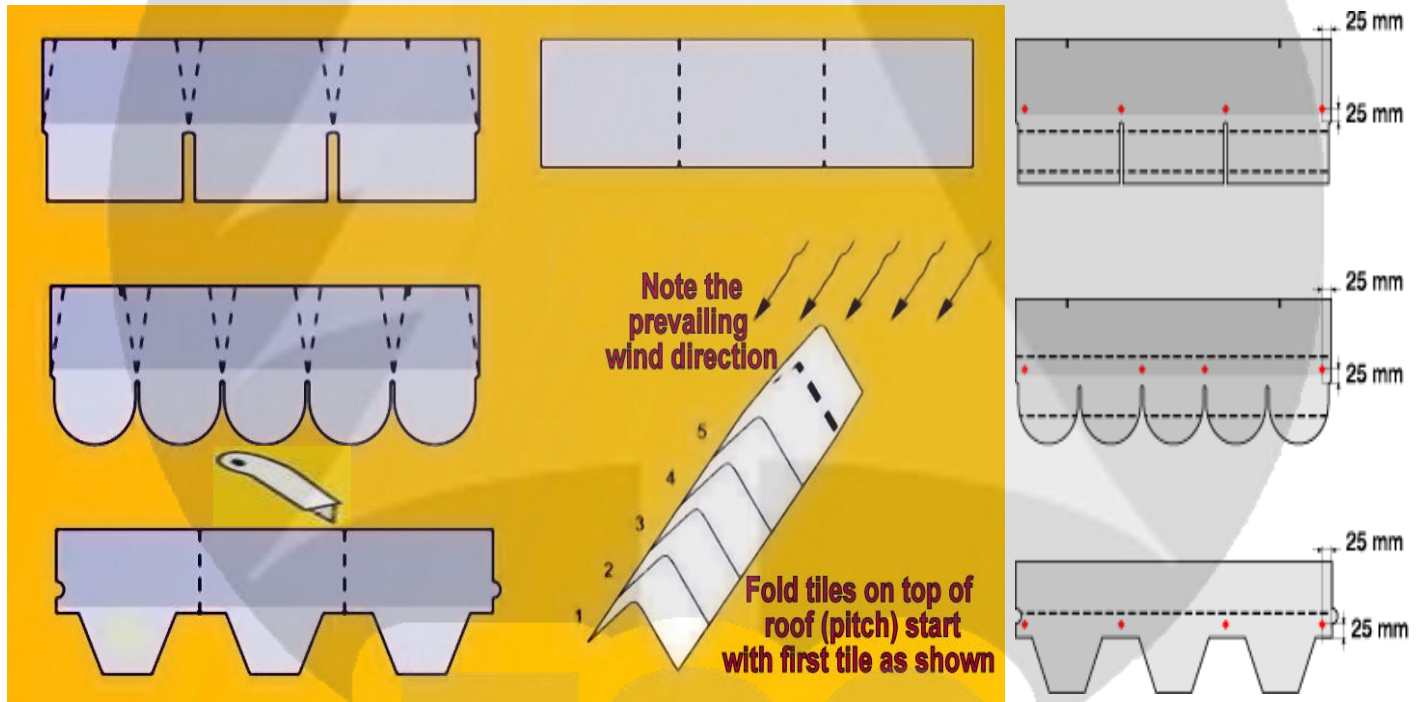

Cold weather conditions lower than 10°C, it is recommended to keep ridge tiles warm to bend in place.

Tile Patterns

DO NOT overlap all the darker section. Refer to the pictures for the correct spacing of tiles. If you fix the tiles with a larger overlap you will not have enough to complete your roof.

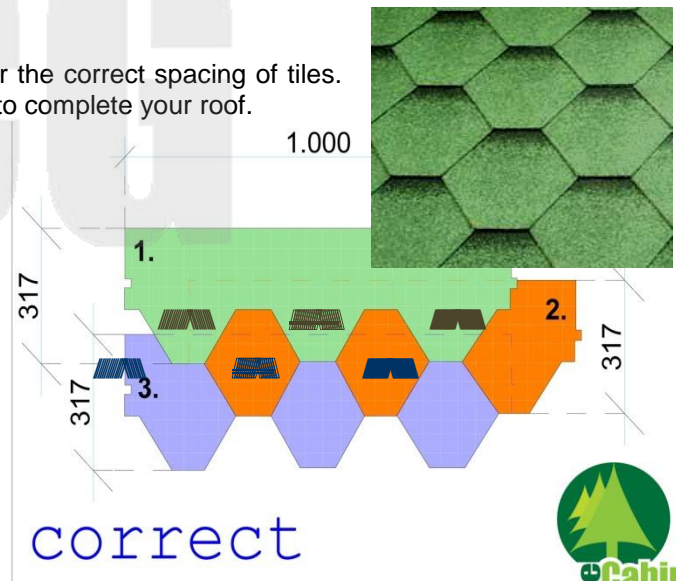
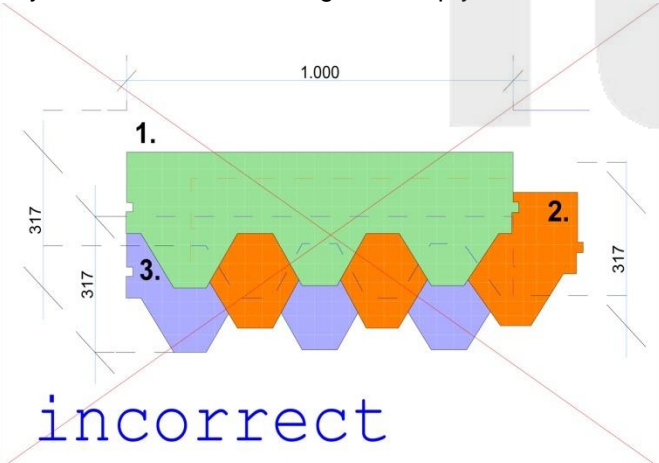

If you have any questions about the installation process of your tiles please contact us before starting. Email for technical help: Technical@CabinGroup.com

